

**PROJECT NAME:-**  
 STRUCTURAL DRAWING OF PROPOSED (B+G+9) ELEVEN STORED RESIDENTIAL BUILDING OF MRS. SUKLA BHOWMICK W/O LATE BALARAM BHOWMICK, SMT. MOUSUMI DAS, W/O SRI. TARUN DAS, SRI. DEBRAJ BHOWMICK, S/O LATE BALARAM BHOWMICK, SMT. AMALA GHOSH W/O MR. JIBAN KRISHNA GHOSH, PRATAP SANKAR GHOSH S/O LATE SHAILENDRA MOHAN GHOSH, SRI. MUKUL MANNA S/O LATE PANCHANAN MANNA, SMT. MONORAMA MANNA W/O SRI. MUKUL MANNA SRI. SURESH RUIDAS S/O SRI. SANATAN RUIDAS, MRS. MAYA RANI CHATTERJEE W/O LATE CHITTARANJAN CHATTERJEE, MR. UTTAM KUMAR CHATTOPADHYAY S/O LATE CHITTARANJAN CHATTERJEE, MR. GOUTAM KUMAR CHATTOPADHYAY S/O LATE CHITTARANJAN CHATTERJEE, MR. SATYAM CHATTOPADHYAY S/O LATE CHITTARANJAN CHATTERJEE (DEVELOPED BY MONDAL CONSTRUCTION) R.S. PLOT NO-15, 16, 17 L.R. PLOT- 124,148,149 U. L. NO-111, L.R. KHATIAN NO-957,963,1357,1358,1665,2033,2034,2035,2153, 2154, 2155, 2156 MOUZA-TETIKHOLA, P.S-NEW TOWN SHIP, DIST-PASCHIM BARDHAMAN.

- NOTES :-**
- (±) 0.00 m LEVEL REFERS TO E.G.L.
  - UNLESS OTHERWISE STATED ALL CONSTRUCTION ACTIVITIES SHALL BE CARRIED OUT CONFORMING TO RELEVANT (INDIAN) STANDARD CODES OF PRACTICE.
  - ALL DIMENSIONS ARE IN MILLIMETERS & LEVELS ARE IN METER. EXCEPT OTHERWISE MENTIONED ALL WRITTEN DIMENSIONS SHALL BE FOLLOWED. ALL LEVELS GIVEN IN STRUCTURAL DRAWINGS ARE IN ACCORDANCE WITH ARCHITECTURAL DRAWINGS AND INDICATE STRUCTURAL LEVEL ONLY (WITHOUT FINISH). HOWEVER ARCHITECTURAL DRAWING TO BE COORDINATED FOR ALL LEVELS.
  - ALL STRUCTURAL DRAWINGS SHALL BE READ ALONG WITH THIS DRAWING AS WELL AS RELEVANT ARCHITECTURAL DRAWINGS.
  - ANY DISCREPANCY IN THE STRUCTURAL AND ARCHITECTURAL DRAWINGS SHALL BE BROUGHT TO THE NOTICE OF STRUCTURAL CONSULTANT BEFORE EXECUTION OF WORK.
  - UNLESS OTHERWISE SPECIFIED ALL REINFORCEMENT TO BE USED SHALL BE T.M.T. BARS OF GRADE Fe-500/500 D CONFORMING TO IS-1786-2008.
  - ADEQUATE CHAIR BARS TO BE PROVIDED TO KEEP THE TOP REINFORCEMENT IN PROPER POSITION.
  - UNLESS OTHERWISE STATED LAP LENGTH OF BARS SHALL BE DEVELOPMENT LENGTH=50xBAR DIA.
  - UNLESS OTHERWISE SPECIFIED DISTRIBUTION REINFORCEMENT SHALL BE 8 T @ 250 C/C
  - CONCRETE COVER TO MAIN REINFORCEMENT SHALL BE AS FOLLOWS:-  
 a) Beam:-25 mm, b) Column:-40mm, c) Slab:-15mm, d) Footing:-50mm, e) R.C.C Wall:-20 mm, f) Stair:- 20mm.
  - Grade of concrete will be m30 for column and m25 for beam and sub structure as per is: 456:2000.
  - Development length 50xd for lap & splices should be provided as per the provisions laid down in SP34:1987

**SIGNATURE OF DEVELOPER/OWNER:-**

**VETTED BY:-**  
 DR. S. N. MUKHERJEE  
 Professor  
 CIVIL ENGINEERING DEPT.  
 JADAVPUR UNIVERSITY  
 KOLKATA-700032, (W.B.)

**TITLE:-**

FOUNDATION LAYOUT PLAN, SCHEDULE OF FOUNDATION, SECTIONAL DETAILS OF FOUNDATION, DETAILS OF PILE CAP, DETAILS OF GRADE BEAM, SECTION OF GRADE BEAM

**SCALE: 1:100, 1:50, 1:25, N.T.S.**

Approved Plan No. 55 on Meeting No. 06/2022-23 Date 29/03/2022  
 Valid upto 15/12/2024  
 DATE : 20.04.2022  
 SHEET NO:- GIDS/STRUC-02-04

**TABLE NO:-3 (SCHEDULE OF PILE CAP)**

PILE CAP MARKED	NAME OF COLUMN	CAP LENGTH (mm)	CAP WIDTH (mm)	THICKNESS (mm)	BOTTOM REINFORCEMENT(A)		TOP REINFORCEMENT(B)		C LINK(C) (BOTH DIRECTION)	SIDE FACE REINFORCEMENT (D)	CUT OFF LVL.
					ALONG LONGER DIRECTION	ALONG SHORTER DIRECTION	ALONG LONGER DIRECTION	ALONG SHORTER DIRECTION			
PC1(3P)	C1,C2,C3,C4,C5,C6, C7,C8,[C10+L6], [C11+L7],C12,C13, C15,C16,C17,C18, C19,C20,C21,C22, C23,C25,C26,C27, C28,[C29+L17],C31, C33,C34,C36,C37, [C38+L27],C40,C41, C42,C43,C44,C45, C46,C47,C48.	SEE LAYOUT PLAN	1200	25R@150 C/C	25R@150 C/C	25R@150 C/C	25R@150 C/C	12 R @100 C/C	16 R @150 C/C	(-) 3.9 m	
PC2(12P)	[C9+C14+LIFT-2], [C24+C35+LIFT-1], [C32+C39+ELEVATOR]	4800	3450	1200	25R@150 C/C	25R@150 C/C	25R@150 C/C	12 R @100 C/C	16 R @150 C/C	(-) 5.25 m	
PC3(9P)	C30+L18.	3450	3450	1200	25R@150 C/C	25R@150 C/C	25R@150 C/C	12 R @100 C/C	16 R @150 C/C	(-) 3.9 m	

**TABLE NO:-04 (SCHEDULE OF ISOLATE FOOTING)**

FOUNDATION TYPE	COLUMN UNDER	L (mm)	B (mm)	C (mm)	D (mm)	E (mm)	F (mm)	R (mm)	S (mm)
F1	L1-L36 EXCEPT L6,L7,L17,L18,L27	1250	1250	300	300	-	-	-	1400 X1400

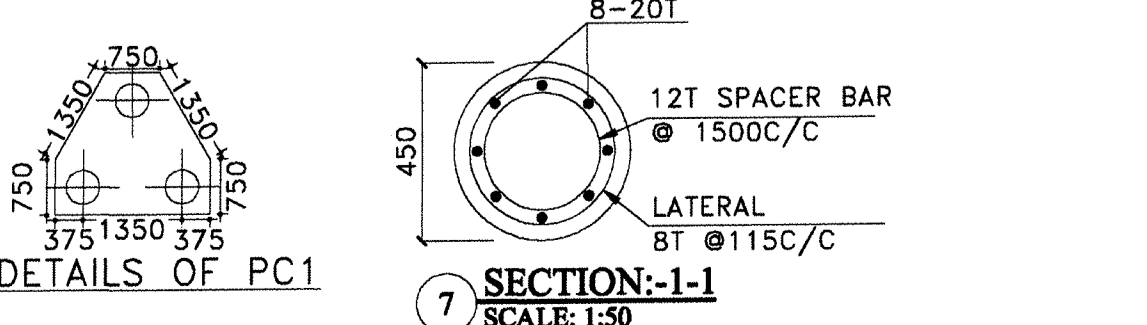

**(SCHEDULE OF PILE-450 DIA) MIN CEMENT CONTENT IN CONCRETE SHALL BE = 400kg/m<sup>3</sup>**

LEGEND	DIA OF PILE (MM)	CUT-OFF LEVEL (M)	PILE LENGTH (M)	MAIN REINFORCEMENT	PILE CAPACITY			REMARKS
					SAFE WORKING LOAD IN TONS	COMPRESSION	TENSION	
⊕	450 DIA	EL.(-)3900MM EXCEPT PILES UNDER LIFT PIT	22.0	8-20 R (ALTH)	-	-	-	CUT OFF LEVEL IS (-) 5250 MM LEVEL FROM E.G.L FOR LIFT

NOTE:- ABOVE ARE THE PILE DETAILS ADOPTED. THESE MUST BE ENSURED AT SITE BY PILE LOAD TEST.

**SIGNATURE OF ARCHITECT:-**  
 VAISHNAVI K. ARAMQATHALVE  
 CONSULTING ARCHITECT  
 CA/2018/101108

**SIGNATURE OF STRUCTURAL ENGINEER:-**  
 HANU G. GHOSH  
 Structural Engineer  
 Lic. No. L.B.PM189JMC.DMC/CPD/1165  
 DCE, B-TECH, G.I.D.S. Durgapur-16  
 Contact No. 9333233331

**SIGNATURE OF GEO-TECHNICAL ENGINEER:-**  
 MANOJ MAITY  
 Geotechnical Engineer  
 Lic. No. L.B.PM189JMC.DMC/CPD/1165  
 DCE, B-TECH, G.I.D.S. Durgapur-16  
 Contact No. 9333233331

**SCALE: 1:100, 1:50, 1:25, N.T.S.**

